



## *Trauma-Informed Care → Trauma-Informed Design*

You may recall that last year the leadership team of Justice Housing Yakima hosted a “design charette,” in which a number of Camp Hope residents sat with our team to brainstorm how to make Cottage Hill Place best fit their



needs. Some of these discussions prompted our architect, Nathan Poel of Inversion Design/Build, to propose that we engage in a process of “Trauma Informed Design.” He proposed this idea to the JHY Board, and we think it’s exactly what CHP needs.

Nearly all of our potential residents at CHP will likely have experienced multiple traumatic events in their lives. The impacts of traumas can last a long time, which is why people in the human service fields have been providing “trauma-informed care” to help providers be better able to empathize with the unique needs of their clients.

There is a lot of information coming out now about the many ways trauma-informed design can be implemented in multiple settings, but one thing we hear from potential CHP residents is the need for safety; both actual safety and the perception of safety. This has led us to re-think the layout of CHP, and to move from nearly thirty

separate tiny homes to rows or European-style cottages, grouped together in four larger buildings. With this design, there will be a clear demarcation between resident’s private space (the inside of their cottage,) semi-private space (their front porch,) semi-public space (their yard in front of their cottage,) and public space (the sidewalk and other common areas.) This also eliminates most of the areas around each cottage that may not have clear boundaries.

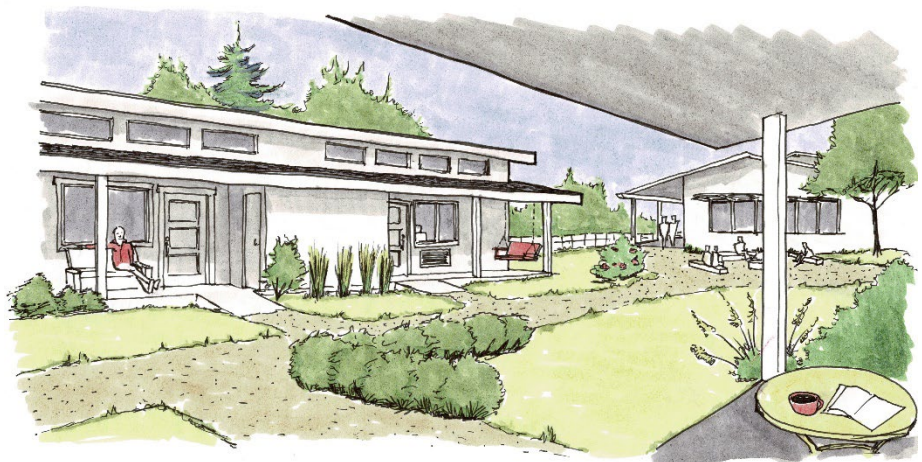

*1 Preliminary new design sketch of CHP*

Most importantly, trauma-informed design is as much a *process* as it is a product. This means we’ll continue to consult with likely future residents about how to best create not just a place to sleep but a place that feels safe, comfortable, and like home. We’ll be finalizing our design in the next few weeks – so look for more information soon!